

2022-06-01-1605

Main Level

Roofl

1808.65 Surface Area
334.94 Total Perimeter Length

18.09 Number of Squares

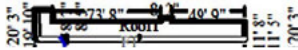

DESCRIPTION	QUANTITY	UNIT PRICE	TAX	O&P	RCV	DEPREC.	ACV
1. Remove Metal roofing	1,809.00 SF	0.52	0.00	188.14	1,128.82	(0.00)	1,128.82
2. R&R Rafters 2x4 Gable, per SF *	405.00 SF	3.29	37.51	274.00	1,643.96	(0.00)	1,643.96
3. Battens 2x4 *	4.10 SF	289.91	51.96	248.12	1,488.71	(0.00)	1,488.71
4. R&R Girder/strong back*	42.00 LF	15.58	32.52	137.38	824.26	(0.00)	824.26
5. R&R 2" x 4" plate*	50.00 LF	3.83	5.73	39.44	236.67	(0.00)	236.67
6. Fascia metal *	60.00 LF	12.87	12.97	157.04	942.21	(172.73)	769.48
7. Paint exterior fascia *	176.00 LF	2.43	1.29	85.80	514.77	(107.24)	407.53
8. Roof panel - ribbed - 26 gauge - up to 1"*	1,809.00 SF	5.84	401.26	0.00	10,965.82	(2,412.48)	8,553.34
9. R&R Flashing L flashing galvanized 22" break*	156.00 LF	8.47	18.63	267.98	1,607.93	(0.00)	1,607.93
10. R&R Paint- L flashing 22" L shape*	156.00 LF	3.65	16.35	117.16	702.91	(123.43)	579.48
11. Ridge cap & rake metal roofing*	20.00 LF	6.08	3.62	25.04	150.26	(27.55)	122.71
12. R&R Soffit metal	1,292.00 SF	7.62	363.21	2,041.64	12,249.89	(2,160.55)	10,089.34
Totals: Roofl			945.05	3,581.74	32,456.21	5,003.98	27,452.23

General Expense

DESCRIPTION	QUANTITY	UNIT PRICE	TAX	O&P	RCV	DEPREC.	ACV
18. General clean - up	8.00 HR	40.30	0.00	64.48	386.88	(0.00)	386.88
21. Dumpster load - Approx. 12 yards, 1-3 tons of debris	1.00 EA	510.00	0.00	102.00	612.00	(0.00)	612.00
Totals: General Expense			0.00	166.48	998.88	0.00	998.88
Total: Main Level			945.05	3,748.22	33,455.09	5,003.98	28,451.11
Line Item Totals: 2022-06-01-1605			945.05	3,748.22	33,455.09	5,003.98	28,451.11

Grand Total Areas:

0.00 SF Walls	0.00 SF Ceiling	0.00 SF Walls and Ceiling
0.00 SF Floor	0.00 SY Flooring	0.00 LF Floor Perimeter
0.00 SF Long Wall	0.00 SF Short Wall	0.00 LF Ceil. Perimeter
0.00 Floor Area	0.00 Total Area	0.00 Interior Wall Area
439.16 Exterior Wall Area	0.00 Exterior Perimeter of Walls	
1,808.65 Surface Area	18.09 Number of Squares	334.94 Total Perimeter Length
0.00 Total Ridge Length	0.00 Total Hip Length	

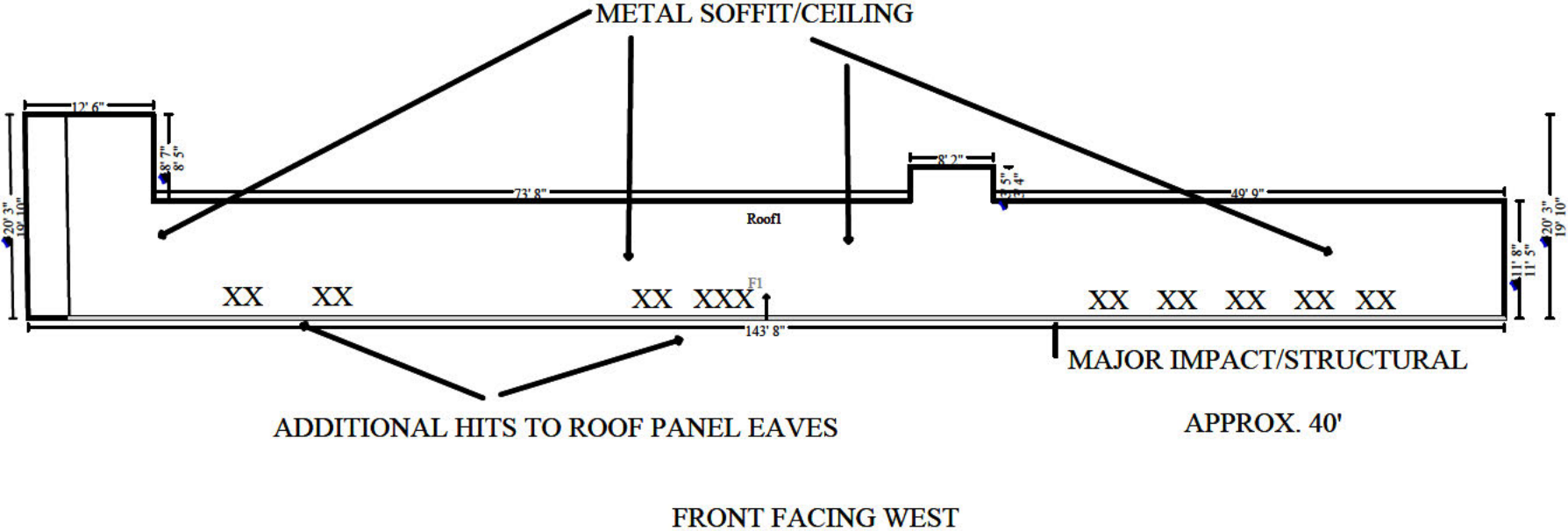

Sketch Roof Annotations

Main Level

Face	Square Feet	Number of Squares	Slope - Rise / 12
F1	1,808.65	18.09	2.42
Estimated Total:	1,808.65	18.09	

1 31-DSCN5617

SENIORS CITIZEN CENTER



2 46-DSCN5632

RISK /BUILDING N.E. CORNER



3 1-DSCN5587

APPROX 40' STRUCTURAL
DAMAGE



4 2-DSCN5588

SO/ END OF CANOPY



5 3-DSCN5589

RAKED THE ROOF EAVE SOFFIT



6 4-DSCN5590

PRE FORMED 2X RAFTER
DESTROYED



7 5-DSCN5591

2X4 PLATE



8 6-DSCN5592

DLB 2X6 STRONG BACK



9 26-DSCN5612

ANOTHER VIEW OF STRUCTURE



10 27-DSCN5613



11 7-DSCN5593

M-PANEL CEILING RUINED



12 8-DSCN5594

ANOTHER VIEW



13 9-DSCN5595

SHOWS THE TIE-IN TO THE
PARAPET WALL



14 10-DSCN5596

R-PANEL 9" O/C METAL ROOF



15 11-DSCN5597

ROOF PANELS DAMAGED



16 12-DSCN5598

THE ROOF PANELS BEYOND
THE 40' SOUTH RUN HAS
3-ADDITIONAL HITS TO EAVES



17 13-DSCN5599

METAL RAKE



18 15-DSCN5601

WALL FISSURE NON-RELATED



19 16-DSCN5602

DLB 2X6 STRONG BACK
DAMAGED



20 17-DSCN5603

CEILING / SOFFIT PANELS
SHIFTED AND BUCKLED



21 18-DSCN5604

5" SQ STEEL SUPPORT POSTS
APPEAR GOOD



22 19-DSCN5605

NO MOVEMENT SEEN



23 20-DSCN5606

POSTS ATTACHED /STABLE



24 21-DSCN5607

ADDITIONAL DAMAGE TO ROOF
PANELS BEYOND THE 40' RUN
THIS IS AN APPROX AT THE 75'
FROM SO END AND ABOUT 18'
RUN



25 23-DSCN5609

FAR NORTH END OF THE ROOF
IS OK



26 24-DSCN5610

THE ROOF EAVE DAMAGED AT
NEAR TRUCK IS AT THE 110"
FROM FAR SO. END



27 25-DSCN5611

ROOF ONLY TO THIS POINT THE
STRUCTURE AND FACIA IS
GOOD



28 28-DSCN5614

METAL FACIA DAMAGED



29 29-DSCN5615

FAR SO. END FROM THIS POINT
HEAVY TO LIGHT DAMAGE
STRUCTURAL AND ROOF
RELATED PASS THIS POINT TO
THE N. IS SOFFIT/CEILING DMG



30 30-DSCN5616

CEILING PANELS



31 32-DSCN5618

N END OF THE BLDG



32 33-DSCN5619

N END FACIA GOOD



33 34-DSCN5620

SEE THE CEILING PANELS



34 35-DSCN5621



35 37-DSCN5623

CEILING WAVEY



36 39-DSCN5625

WALL APPEAR OK



37 40-DSCN5626

WALLS AND WALK NO VEHICLE



38 41-DSCN5627

SO END WALK OK



39 42-DSCN5628

WALLS OK NO IMPACT

